

# SCREW CONVEYORS

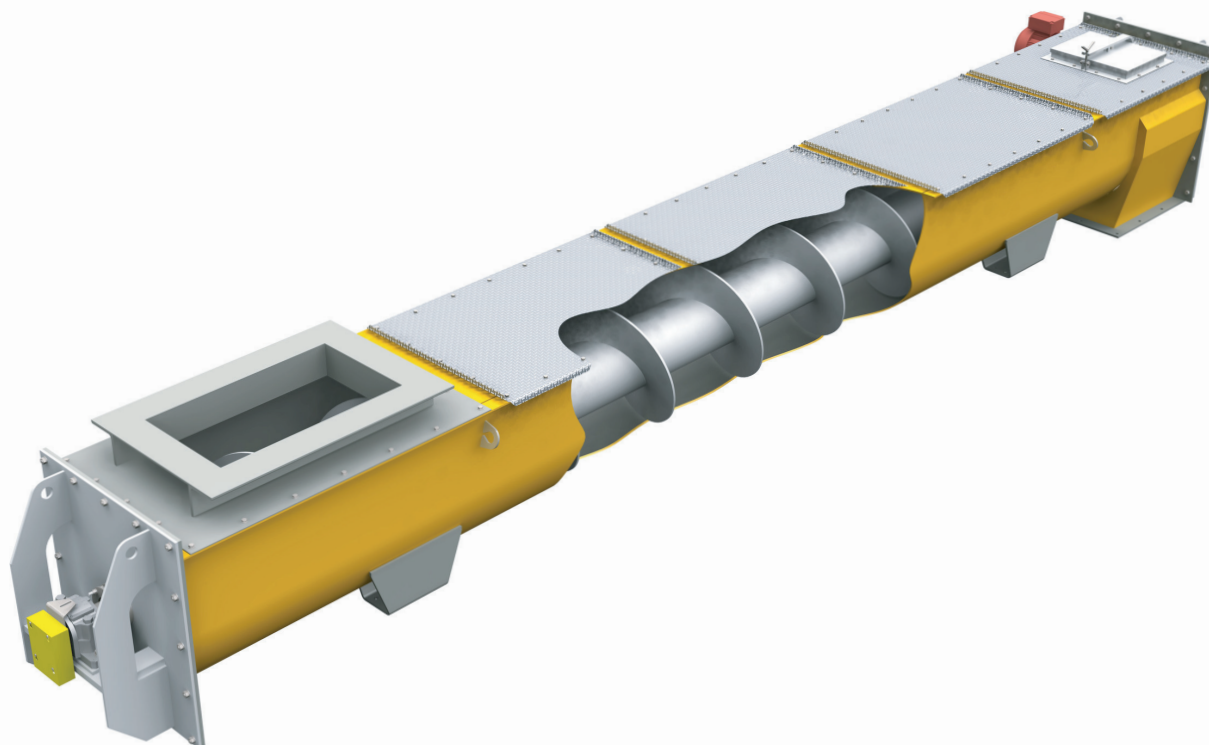

A screw conveyor is one of the most economical ways for transferring bulk materials over short distances.

Besides transferring materials from one place to another, several other purposes of use can be found for screw conveyors, like:

- feeding, dosing and mixing
- distribution of material flow
- cooling (double-wall special design)
- humidifying (when furnished with internal water nozzles)

To your specific purpose of use and material handled we can provide:

- standard modular design interchangeable for replacements or additions to existing installations
- horizontal, inclined and vertical designs
- tubular or U-shaped conveyor trough
- screws with spiral flights for difficult sticky materials
- screws with wear-resistant facing for demanding applications
- digger teeth on dosing feeder screws

The dust-tight and spill free screw conveyor is ideal for handling biomass fuels (woodchips, bark, peat), solid re-covered fuel (SRF), coal, ash, cement, lime and minerals.

Simple construction means easy maintenance.

Screw diameter (mm)	Capacity (m <sup>3</sup> /h)		Recommended max. length
	0°	30°	
250	15	3	6,5
315	26	6	7,0
400	55	13	8,5
500	110	35	8,6
630	220	43	10,0
710	300	45	11,0
800	330	75	11,0
900	450	100	11,0
1000	520	170	12,0
1120	740	200	12,0
1250	850	250	12,0
1400	1200	315	14,0
1600	1400	450	14,0

*The values in this table are only indicative. Capacities have been calculated for handling woodchip or similar materials at the inclinations of 0° and 30°.*